

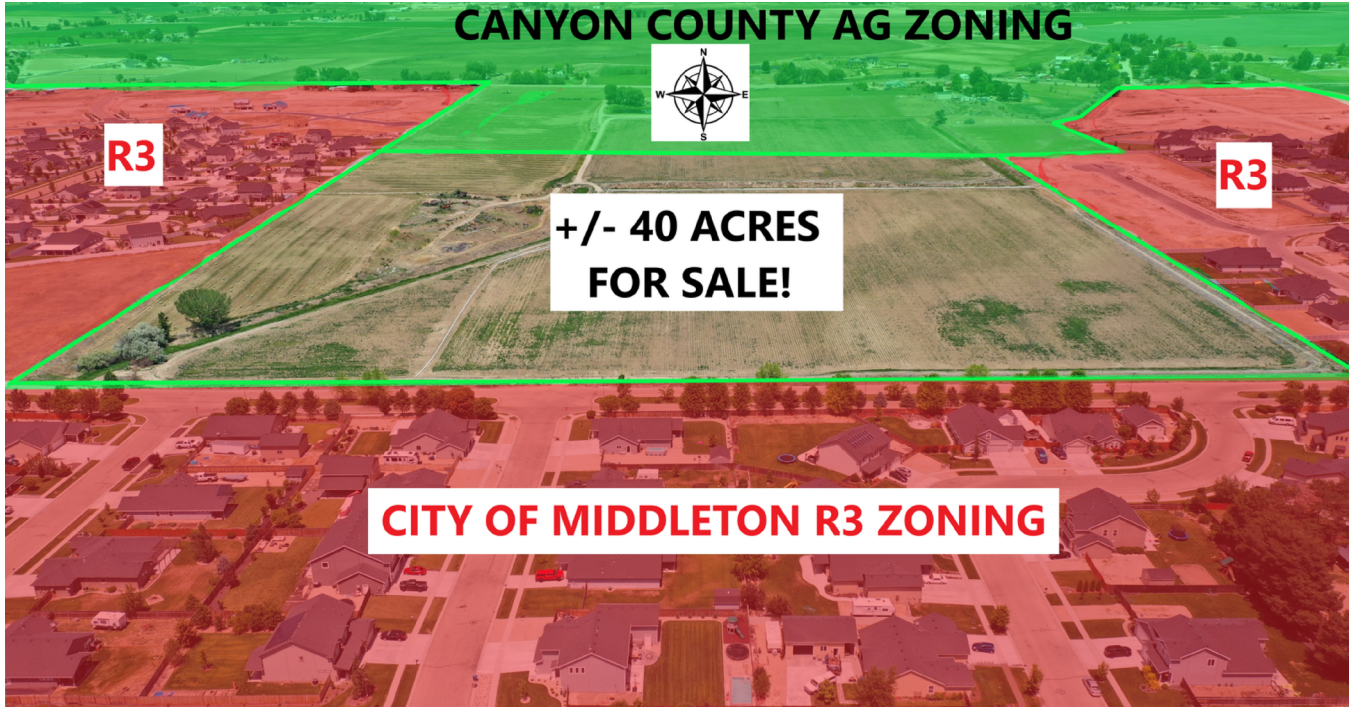

# WHITE BARN REAL ESTATE

Mills & Co. Realty Inc.

## Potential Development - 40 Acres TBD Meadow Park, Middleton ID 83644



**Location:** From Hwy 44 in Middleton, N on Middleton Rd 1.67 miles. W Meadow Park 1/4 mile, property on N side.

**Asking Price: \$5,250,000 Size: 40 Acres**

**Parcel #: R3756100000**

### Property Description:

Nice potential Development property in the path of growth in fast growing Middleton! Approximately 40 acres. Currently zoned AG in Canyon County and contiguous to the City of Middleton R3 Residential Zoning on 3 sides. City Sewer and Water are adjacent to site on west and south boundaries. please verify details and future plans with City of Middleton. Thank you! BTVAI.

Legal Description: SW 1/4 of the NE 1/4 of Section 31, Township 5 North, Range 2 West of the Boise Meridian



### Agents:

Matt Wilke 208.412.9803 Matt@MyWhiteBarn.com MyWhiteBarn.com	April Wilke 208.941.1839 April@MyWhiteBarn.com MyWhiteBarn.com
---	---